

Whilst every attempt has been made to ensure the accuracy of the floor plan contained here, measurements of doors, windows, rooms and any other items are approximate and no responsibility is taken for any error, omission, or mis-statement. This plan is for illustrative purposes only and should be used as such by any prospective purchaser. The services, systems and appliances shown have not been tested and no guarantee as to their operability or efficiency can be given
 Made with Metropix ©2021

TOTAL APPROX. FLOOR AREA 50.8 SQ.M. (547 SQ.FT.)

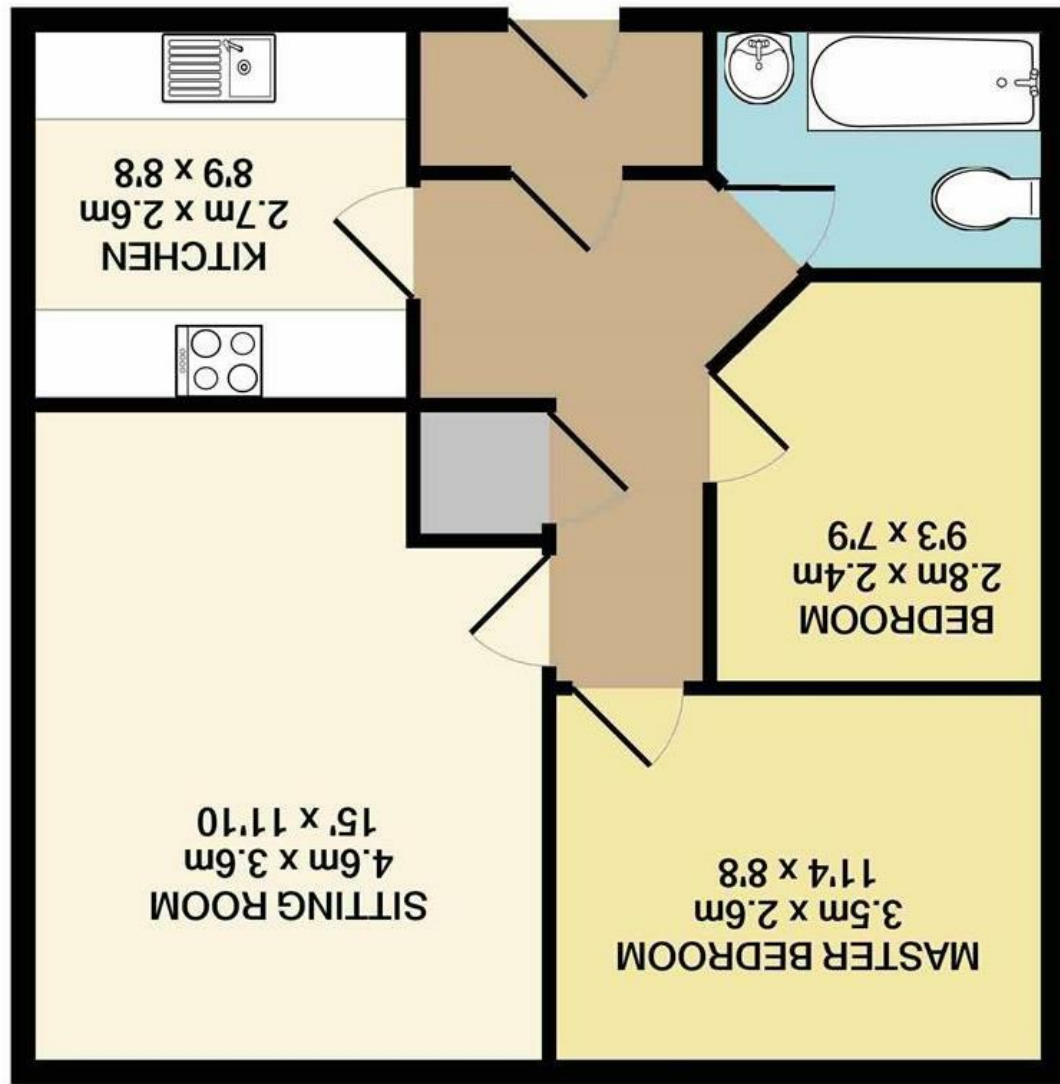

Disclaimer – In accordance with the Property Misdescriptions Act, the company gives notice that all descriptions, references to condition, necessary permissions for use and other details are given in good faith and believed to be correct, but any intending lessees do not rely on them as statements of fact, but must satisfy themselves by inspection or other means, as to their accuracy.

England & Wales	
EU Directive 2002/91/EC	
Very energy efficient - lower running costs	(92 plus) A
	(81-91) B
	(69-80) C
	(55-68) D
	(39-54) E
	(21-38) F
Not energy efficient - higher running costs	(1-20) G
Current	74
Potential	75



Whitworth Court | Norwich | NR6
 Guide Price £130,000



abbotFox presents this spacious two-bedroom apartment. Located within easy reach of a variety of local amenities. An ideal opportunity for any first-time buyer or buy-to-let investor. With accommodation comprising of an entrance hall, lounge, kitchen, double bedroom and bathroom, this home has been well maintained by the current owners. An internal viewing comes highly recommended.

